

NATIONAL COMMITTEE RESOLUTION OF ACCEPTED EBSS ANTENNA/ PAD LOCATIONS MAY 2015

SKETCH 1 – LANDING BOARD ENTRY

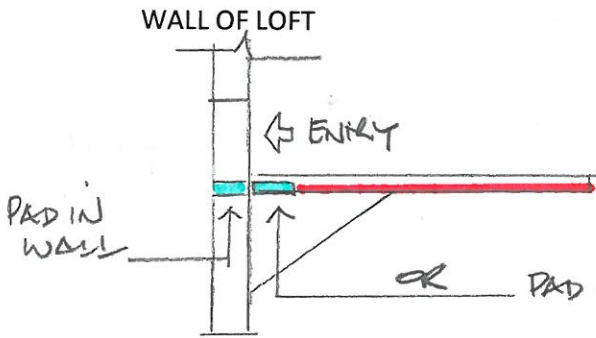

→ PAD'S LEGAL ZONE
 → PAD'S ILLEGAL ZONE

* ONE PAD WIDE MEANS THE WIDTH OF ONE PAD. MORE PADS CAN BE ADDED ALONG THE FACE OF THE LOFT BUT NOT OUT. *

SKETCH 2 – SPUTNIK TRAP ENTRY

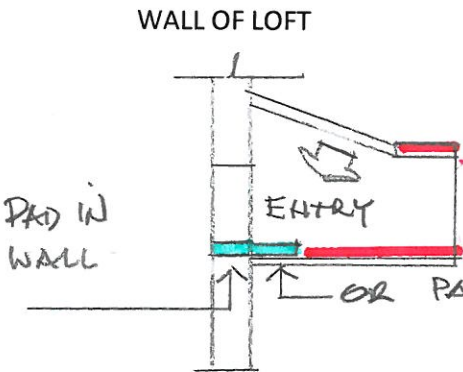

OR PAD ON FLOOR OF SPUTNIK TOUCHING LOFT FACE (ONE PAD WIDE)

SKETCH 3 – FLYIN TRAP ENTRY

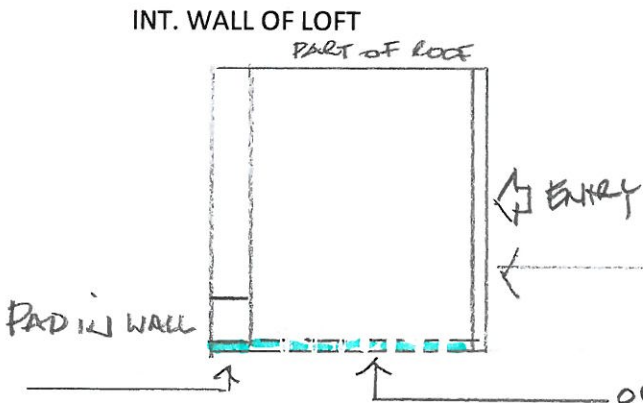

MAYBE SOLID OR WIRE DOORS THAT ARE CLOSED WHEN NOT FLYING, TRAINING OR RACING

SKETCH 4 – FLYIN TRAP RAMPED FLOOR ENTRY

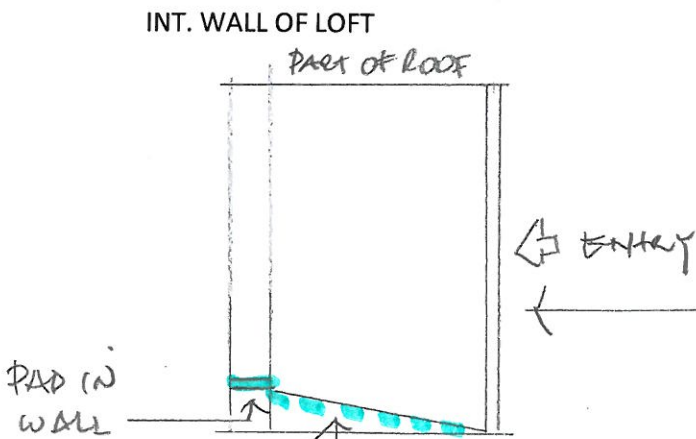

AS ABOVE

OR LOCATED WITHIN RAMP OF FLYIN (ONE PAD WIDE ONLY)